

► **Arbeitswellen Typ B, C, M**

► **Working shafts type B, C, M**

Abbildung <i>picture</i>	Art.Nr. Welle <i>shaft</i>	Typ <i>type</i>	Länge/m <i>length/m</i>	Anschluss <i>connection</i>	Art.Nr. Wellenseele <i>inner core</i>	Art.Nr. Schlauch <i>protective casing</i>
1	102 001	B 6,0	1,5	DIN30/KB 180	112 001	122 001
	102 002	B 7,1	1,5	DIN20/KB 180	112 002	122 002
	11 020 022	B 7,1	2,0	DIN20/KB 180	11 120 022	11 220 022
	102 003	B 7,2	1,5	DIN30/KB 180	112 003	122 003
	11 020 032	B 7,2	2,0	DIN30/KB 180	11 120 032	11 220 032
	102 004	B 10,1	1,5	DIN30/KB 180	112 004	122 004
	11 020 042	B 10,1	2,0	DIN30/KB 180	11 120 042	11 220 042
	102 005	B 10,2	1,5	DIN30/KB 250	112 005	122 005
	11 020 052	B 10,2	2,0	DIN30/KB 250	11 120 052	11 220 052
	102 006	B 12,0	2,0	DIN30/KB 310	112 006	122 006
102 007	B 15,0	2,0	DIN40/KB 310	112 007	122 007	
2	103 001	C 6,0	1,5	GZ6-DIN30/KB 180	113 001	123 001
	103 002	C 7,0	1,5	GZ7-DIN30/KB 180	113 002	123 002
	11 030 022	C 7,0	2,0	GZ7-DIN30/KB 180	11 130 022	11 230 022
	103 003	C 10,1	1,5	GZ10-DIN30/KB 180	113 003	123 003
	11 030 032	C 10,1	2,0	GZ10-DIN30/KB 180	11 130 032	11 230 032
	103 004	C 10,2	1,5	GZ10-DIN30/KB 250	113 004	123 004
	11 030 042	C 10,2	2,0	GZ10-DIN30/KB 250	11 130 042	11 230 042
	103 005	C 12,0	2,0	GZ12-DIN30/KB 310	113 005	123 005
103 006	C 15,0	2,0	GZ15-DIN30/KB 310	113 006	123 006	
3	104 001	M 7,0	1,5	KM32/KB 180	114 001	124 001
	11 040 012	M 7,0	2,0	KM32/KB 180	11 140 012	11 240 012
	104 002	M 10,0	1,5	KM32/KB 250	114 002	124 002
	11 040 022	M 10,0	2,0	KM32/KB 250	11 140 022	11 240 022
	104 003	M 12,0	2,0	KM32/KB 310	114 003	124 003
	104 004	M 15,0	2,0	KM32/KB 310	114 004	124 004

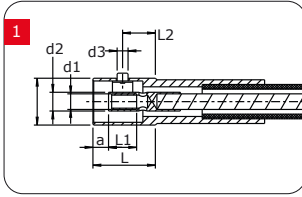

Arbeitswelle Typ B
 - **Motorseite**
Anschluss D = DIN 42995;
 Wellenseele wird geschraubt;
 Schlauch mit Sperrfederkopf

Working shaft type B
 - **Connection D = DIN 42995**
at motor side
 Inner core mounted by screwing;
 outer casing with stop spring lock



Wellen Ø mm	a	D	L	d ₁	d ₂	d ₃	L ₁	L ₂
4	10	30	30	M10	12	8	14	10
6	8	20	20	M6+8	8-10	6	12	8
6+7	10	30	30	M10	12	8	14	10
10	10	30	30	M10	12	8	14	10
12+13	10	30	30	M10	12	8	14	10
15	12	40	40	M14	18	8	20	13
20	12	40	40	M14	23	8	20	13

Arbeitswellen Typ B, C, M

Working shafts type B, C, M

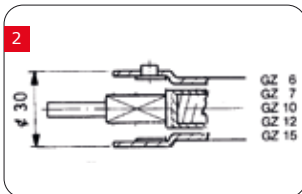

Arbeitswelle Typ C
 - Motorseite **Gleitanschluss GZ**

Working shaft type C
 - **GZ slide connection** at motor side

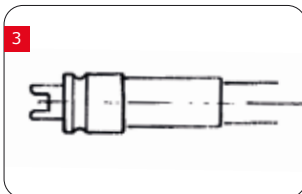
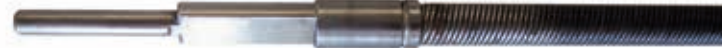

Arbeitswelle Typ M
 - Motorseite **Klaueanschluss KM**

Working shaft type M
 - **Claw connection KM** at motor side



KB 180

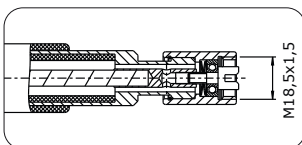

KB 250

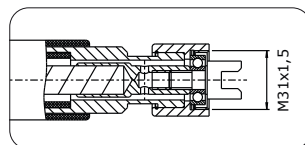

KB 310

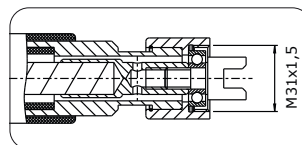

Arbeitswelle Typ B, C, M
 - Handstückseite
Klaueanschluss KB

Working shaft type B, C, M
 - **Claw connection KB** at hand-piece side

